

Inted 4/18/2014

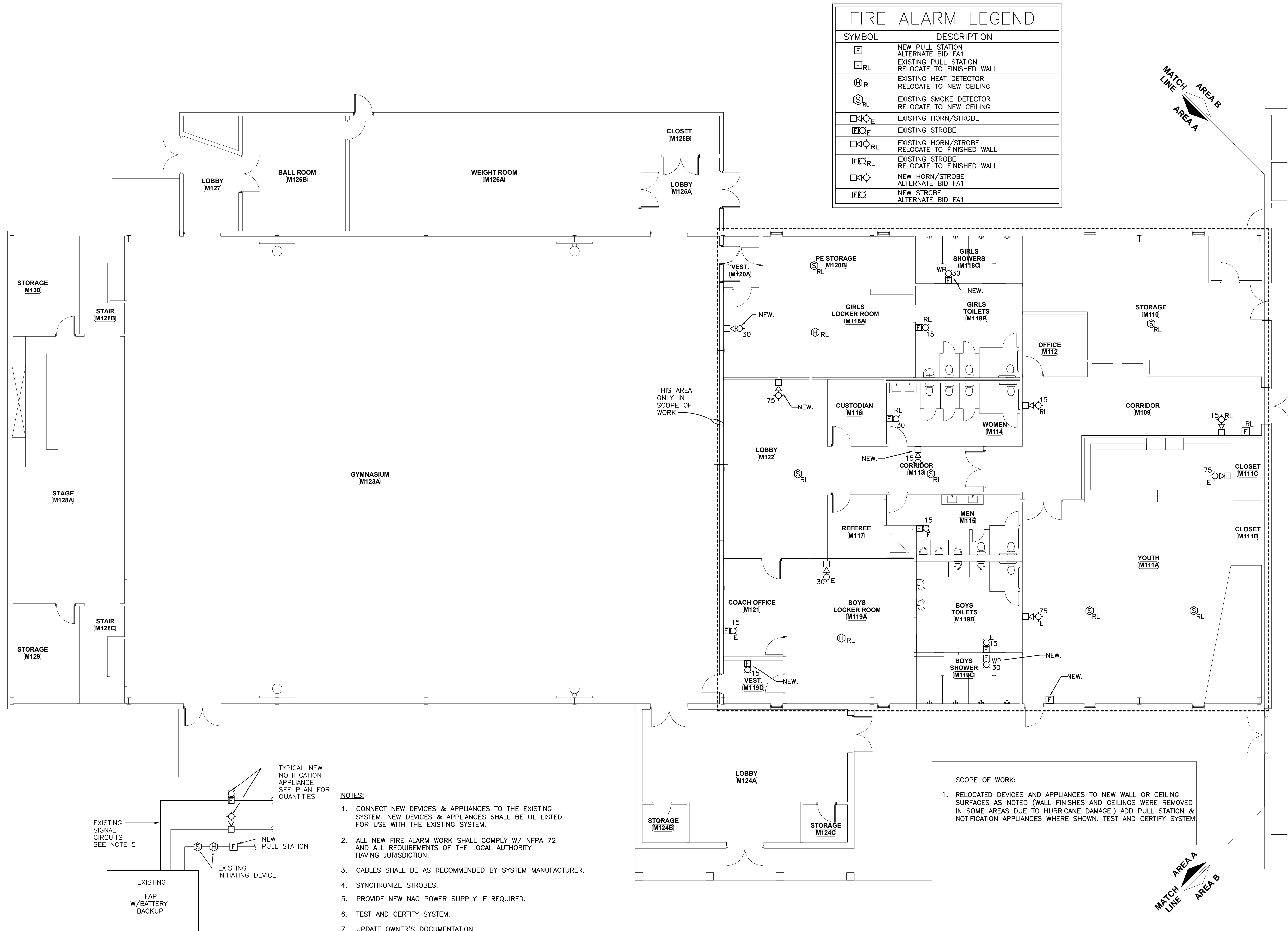

EXISTING FIRE ALARM RISER  
NTS

NOTES:

1. CONNECT NEW DEVICES & APPLIANCES TO THE EXISTING SYSTEM. NEW DEVICES & APPLIANCES SHALL BE UL LISTED FOR USE WITH THE EXISTING SYSTEM.
2. ALL NEW FIRE ALARM WORK SHALL COMPLY W/ NFPA 72 AND ALL REQUIREMENTS OF THE LOCAL AUTHORITY HAVING JURISDICTION.
3. CABLES SHALL BE AS RECOMMENDED BY SYSTEM MANUFACTURER.
4. SYNCHRONIZE STROBES.
5. PROVIDE NEW NAC POWER SUPPLY IF REQUIRED.
6. TEST AND CERTIFY SYSTEM.
7. UPDATE OWNER'S DOCUMENTATION.
8. SHOP DRAWINGS SHALL BE SUBMITTED TO THE AHJ AND SHALL COMPLY WITH THE WILMINGTON FIRE PREVENTION F.A. PLAN REVIEW REQUIREMENTS POLICY.

FIRE ALARM LEGEND

SYMBOL	DESCRIPTION
	NEW PULL STATION ALTERNATE BID FA1
	EXISTING PULL STATION RELOCATE TO FINISHED WALL
	EXISTING HEAT DETECTOR RELOCATE TO NEW CEILING
	EXISTING SMOKE DETECTOR RELOCATE TO NEW CEILING
	EXISTING HORN/STROBE
	EXISTING STROBE RELOCATE TO FINISHED WALL
	EXISTING STROBE RELOCATE TO FINISHED WALL
	NEW HORN/STROBE ALTERNATE BID FA1
	NEW STROBE ALTERNATE BID FA1

SCOPE OF WORK:

1. RELOCATED DEVICES AND APPLIANCES TO NEW WALL OR CEILING SURFACES AS NOTED (WALL FINISHES AND CEILINGS WERE REMOVED IN SOME AREAS DUE TO HURRICANE DAMAGE.) ADD PULL STATION & NOTIFICATION APPLIANCES WHERE SHOWN. TEST AND CERTIFY SYSTEM.

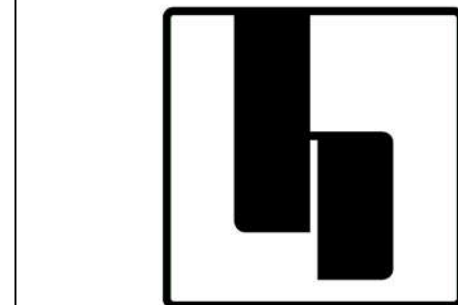

hostellerarchitecture

■ ARCHITECTURE ■ PLANNING

3967 MARKET STREET  
WILMINGTON, NC 28403

PHONE: 910.612.1119

www.hostellerarchitecture.com

CONSULTANTS

10755

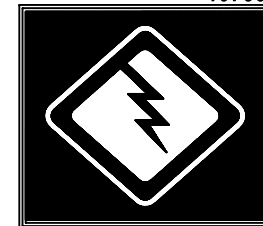

McDOWELL CONSULTING  
ENGINEERS, INC.  
P.O. BOX 367  
HAMPSTEAD, NC 28443  
TEL (910) 270-3747 FAX 270-3779  
NC LICENSE NO. C-2546



RENOVATIONS TO

GRACE  
BAPTIST  
CHURCH

WILMINGTON  
NORTH CAROLINA

CONSTRUCTION DOCUMENTS : 2.8.19

REVISIONS

MARK	DATE	DESCRIPTION
△		
△		
△		
△		

DRAWN BY: RSG PROJ. MGR: GLM

SHEET CONTENT

MESHAW BUILDING (BASE BID)  
FIRST FLOOR PLAN - AREA A  
FIRE ALARM

JOB NO.  
18013

SHEET  
FA101

MESHAW BUILDING (BASE BID)  
FIRST FLOOR PLAN AREA A – FIRE ALARM  
SCALE: 1/8"=1'-0"